

A MODULAR EDGE AI COMPUTER BASED ON NVIDIA JETSON



Overview

Configurable interfaces cut down development costs and speed up time to market for NVIDIA® Jetson™ projects exceedingly. EdgeKit offers an enhanced development kit that is not only equipped for development prototyping but also ready for deployment.

- **Camera Interfaces:** Start your development with the high performance camera sensor that fits your needs
- **JetPack Pre-Flashed:** The latest NVIDIA JetPack OS is pre-installed, saving you time and effort
- **Plug & Play Experience:** Enjoy immediate usability with our selected camera partners and the embedded EdgeControl SDK

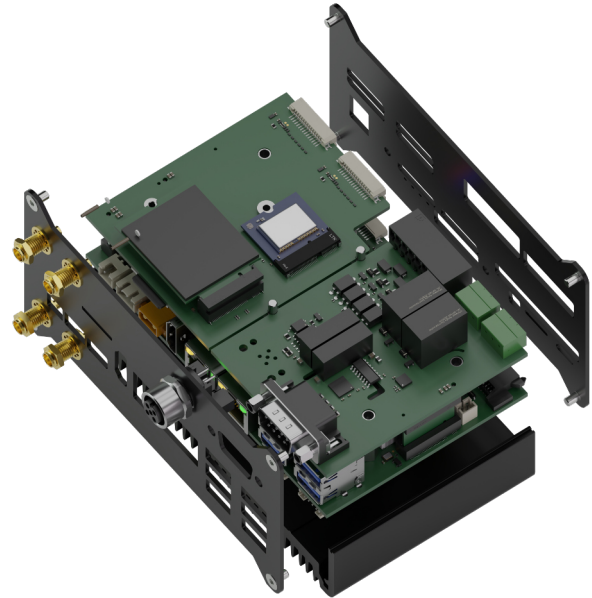

Supported Jetson Boards

	Jetson Xavier NX	Jetson Orin Nano	Jetson Orin NX	Configurable Interfaces		
GPU	384-core NVIDIA Volta with 48 Tensor Cores	1024-core NVIDIA Ampere with 32 Tensor Cores		Camera Interfaces	Industrial	Connectivity
CPU	6-core NVIDIA Carmel ARM® v8.2 64-bit	6-core ARM® Cortex® A78AE v8.2 64-bit	6-core / 8-core ARM® Cortex® A78AE v8.2 64-Bit	2x / 4x FPD Link 3	CAN (M12)	WiFi
RAM	8GB / 16GB 128-bit LPDDR4x	4GB 64-bit LPDDR5 / 8GB 128-bit LPDDR5	8GB 128-bit LPDDR5 / 16GB 128-bit LPDDR5	2x / 4x GMSL 2	2x 3 Pin Relay	GPS
Storage	16GB eMMC 5.1	External NVMe		2x / 4x CSI	8x Opto Isolated IO's	LTE
AI Performance	21 TOPS	20 / 40 TOPS	70 / 100 TOPS	2x GBit Ethernet	RS232 / RS422 or RS485	2x / 4x USB
Power	10 / 20 W	5-10 / 7-15W	10-20 / 10-25W			

About PCB Arts

We are your partner for intelligent embedded systems. At PCB Arts, everything revolves around high-end embedded technology and integrated processors. We support you from the development of electronics and embedded software up to serial production of your product.

Contact

PCB Arts GmbH
www.pcb-arts.com
mail@pcb-arts.com
+49 170 8512642

EdgeControl

PCB ARTS

A POWERFUL SDK FOR PLUG AND PLAY EXPERIENCE ON JETSON



Overview

Embedded devices must interact seamlessly with their environment, and that's exactly what EdgeControl was designed for. Our solution offers comprehensive integration with leading camera and PLC manufacturers, and the most important development tools, including CUDA acceleration.

Features:

- **Dashboard:** Get an overview about general EdgeKit performance e.g. CPU, GPU, disk usage, temperatures
- **GMSL / FPD Link drivers:** Enabling latest camera technologies with a mouseclick
- **Python Tools:** JupyterLab, TensorFlow & PyTorch with CUDA acceleration
- **Camera drivers:** Various camera vendors are onboarded including the complete SDK, the drivers and possible device tree changes

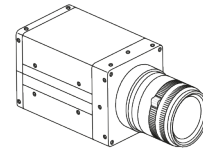

About PCB Arts

We are your partner for intelligent embedded systems. At PCB Arts, everything revolves around high-end embedded technology and integrated processors. We support you from the development of electronics and embedded software up to serial production of your product.

Contact

PCB Arts GmbH
www.pcb-arts.com
mail@pcb-arts.com
+49 170 8512642